

	EXCEL CELL ELECTRONIC CO., LTD.	NO.	A31234		
SPECIFICATION		Edition	1	Page	1

ETBV50 SERIES TERMINAL BLOCK

1. FEATURES:

- 1-1. Screwless design can reduce time for connecting wire
- 1-2. Stackable up to 24 poles
- 1-3. UL 94V-0 grade fire retardant engineering plastic
- 1-4. Be capable of clamping a wide range of wire diameters
- 1-5. Vertical conductor entry compact size for P.C.B.

2. SPECIFICATIONS:

2-1. ELECTRICAL

- 2-1-1. Rating: 10 Amp,300 VAC
- 2-1-2. Dielectric strength: 2000 VAC Min. for 60 sec.
- 2-1-3. Insulation resistance: 100 MΩ Min. at 500 VDC

2.2. MECHANICAL AND ENVIRONMENTAL

- 2-2-1. Operating temperature: -30°C to +110°C (includes temperature rise limit)
- 2-2-2. Wire range: 14AWG to 26AWG
- 2-2-3. Pullout test:
 - pullout force: 50N Min. / 14AWG (Solid)
 - pullout force: 8.9N Min. / 26AWG (Solid)
- 2-2-4. Pitch: 5.0 mm,10.0mm
- 2-2-5. Stripping length: 12 mm
- 2-2-6. No.of pole per Block: 2P to 24P
- 2-2-7. The maximum number of pole per block is not exceeding 24 pcs.
We suggest to divide block into two pieces if total number of pole per book is over 24 pcs.

3. MATERIALS:

- 3-1. Housing: Polyamide 66 (UL 94V-0) resin
- 3-2. End plate: Polyamide 66 (UL 94V-0) resin
- 3-3. Push Button: Polyamide 66 (UL 94V-0) resin
- 3-4. Terminal: Tin plated over Copper Alloy
- 3-5. Spring: Stainless Steel

ECE	EXCEL CELL ELECTRONIC CO., LTD.	NO.	A31234		
SPECIFICATION		Edition	1	Page	2

4. PART NUMBERING SYSTEM:

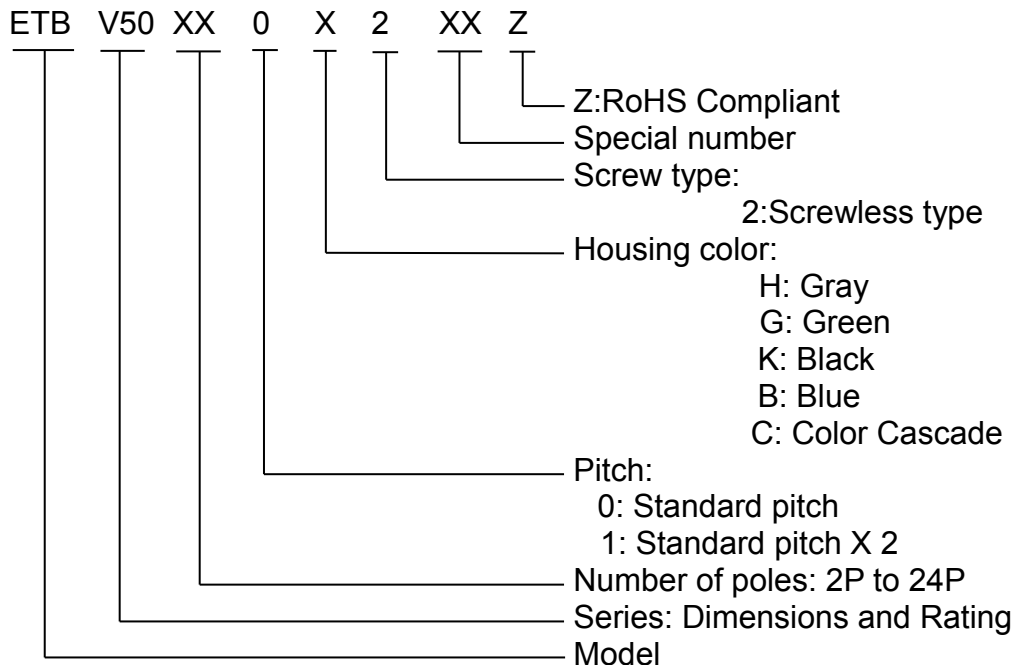

5. PACKING:

5-1. PACKING METHOD

5-1-1. Terminal blocks are packed into plastic bags and then packed into boxes.

5-1-2. Terminal blocks are packed into IC Tube as an inner packing unit, then ten IC Tube are bundled with rubber bands.

Length of IC Tube: 560 mm

5-2. INFORMATION ON LABEL (stuck to each bundle of IC Tubes/each bag)

- | | |
|-----------------|------------------------|
| (1) DESCRIPTION | (7) DATE |
| (2) LOT NO. | (8) MANUFACTURERS NAME |
| (3) QUANTITY | (9) ELECTRICAL RATING |
| (4) TESTER NO. | (10) TEMPERATURE |
| (5) ECE MARK | (11) CONDUCTOR SIZE |
| (6) QC STAMP | |

6. DRAWINGS:

Terminal block dimensions: see attached drawing

ETBV50XX0X2XXZ SERIES DIMENSIONS

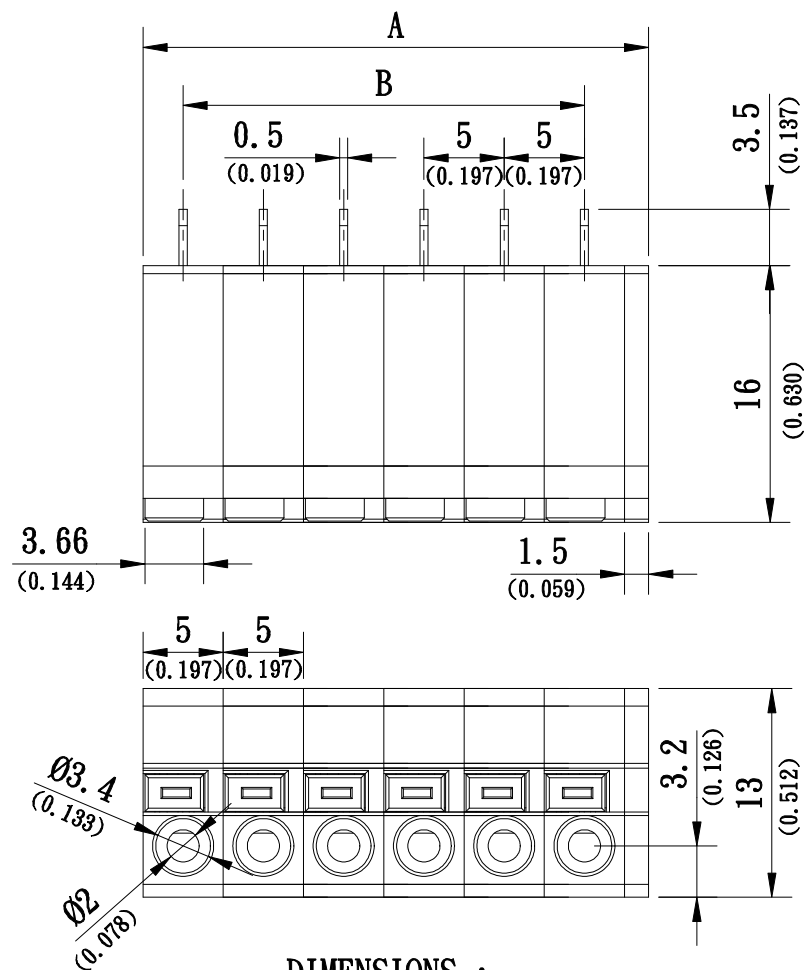

DIMENSIONS :

DIM.	Poles	2	3	4	5	6	7	8	9	10	11	12	13	14	15	16	17	18	19	20	21	22	23	24
A		11.5 (0.453)	16.5 (0.650)	21.5 (0.864)	26.5 (1.043)	31.5 (1.240)	36.5 (1.437)	41.5 (1.634)	46.5 (1.831)	51.5 (2.028)	56.5 (2.224)	61.5 (2.421)	66.5 (2.618)	71.5 (2.815)	76.5 (3.012)	81.5 (3.209)	86.5 (3.406)	91.5 (3.602)	96.5 (3.799)	101.5 (3.996)	106.5 (4.193)	111.5 (4.390)	116.5 (4.587)	121.5 (4.783)
B		5 (0.197)	10 (0.394)	15 (0.591)	20 (0.787)	25 (0.984)	30 (1.0181)	35 (1.378)	40 (1.575)	45 (1.772)	50 (1.969)	55 (2.165)	60 (2.362)	65 (2.559)	70 (2.756)	75 (2.953)	80 (3.150)	85 (3.349)	90 (3.546)	95 (3.743)	100 (3.94)	105 (4.137)	110 (4.334)	115 (4.531)

P. C. B. LAOUT

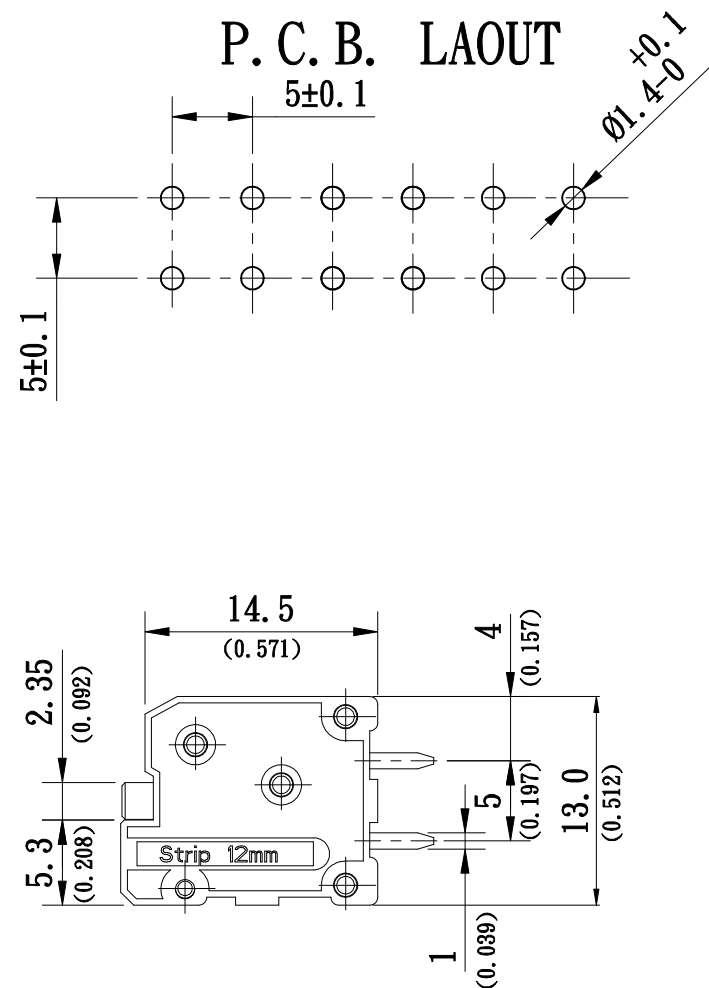

NO.	DETAILS	ALTERED BY	DATE	NORMAL TOLERANCE		EXCEL CELL ELECTRONIC CO., LTD.					PART NUMBER		ETBV50XX0X2XXZ	
				RANGE	TOLERANCE									
				0-1	±0.1	CHECK	Gary Kuo 2019/12/30	DESIGN 王裕欣 2016/09/12	DRAWN 楊博宇 2019/12/30	UNIT MM (INCH)			PART NAME	
				1-4	±0.3								ETBV50	
				4-16	±0.5								TYPE	
				16-63	±0.8								2P~24P	
				63-250	±1.0								FILE NAME	
				X.	±5°								ETBV50XX0X4XXZA. DWG	
				X. X	±2.5°								EDITION	
											PROJECTION		A	

ETBV50XX1X2XXZ SERIES DIMENSIONS

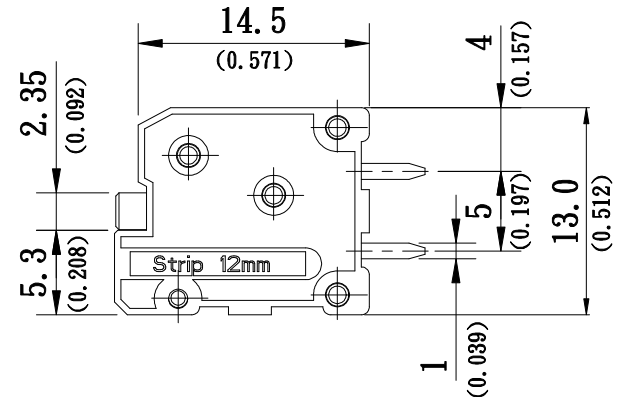
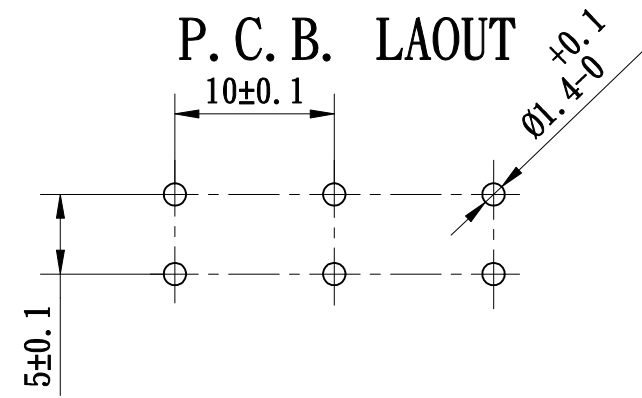
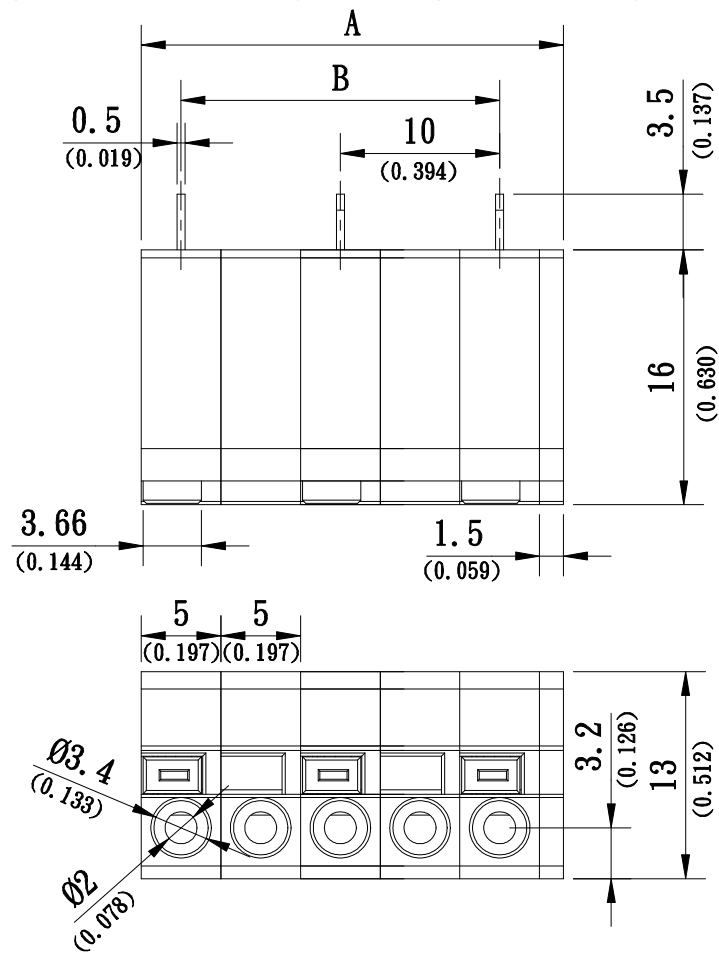

DIMENSIONS :

DIM. \ Poles	2	3	4	5	6	7	8	9	10	11	12
A	16.5 (0.65)	26.5 (1.043)	36.5 (1.437)	46.5 (1.831)	56.5 (2.224)	66.5 (2.618)	76.5 (3.012)	86.5 (3.406)	96.5 (3.799)	106.5 (4.193)	116.5 (4.587)
B	10 (0.394)	20 (0.787)	30 (1.0181)	40 (1.575)	50 (1.969)	60 (2.362)	70 (2.756)	80 (3.150)	90 (3.546)	100 (3.94)	110 (4.334)

NO.	DETAILS	ALTERED BY	DATE	NORMAL TOLERANCE		EXCEL CELL ELECTRONIC CO., LTD.					PART NUMBER	ETBV50XX1X2XXZ	
				RANGE	TOLERANCE								
				0-1	±0.1	CHECK	Gary Kuo 2019/12/30	DESIGN 王裕欣 2016/09/12	DRAW 楊博宇 2019/12/30	UNIT	MM (INCH)	PART NAME	ETBV50
				1-4	±0.3					SCALE	2:1	TYPE	2P~24P
				4-16	±0.5					SIZE	A4	FILE NAME	ETBV50XX1X4XXZA. DWG
				16-63	±0.8					PROJECTION		EDITION	A
				63-250	±1.0								
				X	±5°								
				X. X	±2.5°								