

Type MEC-DL

Low Profile DC Filter Capacitor

Shizuki™ MEC-DL Low Profile Capacitors are designed with PCB board mounting in mind.

Their lead spacing and compact size are conducive for low inductance ($<1\text{nH}$ per mm of lead spacing.) They are available with a single lead or dual leads depending on the current or application requirements.



General Specifications

Parameter	Value
Capacitance	13 μF – 66 μF
Tolerance	$\pm 10\%$
Rated voltage	450, 850VDC
Temperature Range (operational)	-40/85C
Temperature Range (storage)	-40/105C
RMS Current	Up to 13 Arms
Standards	IEC61071
Case	PBT UL-94V-0 Standard
Fill Material	Epoxy
Terminals	Tin Plated Copper Wire
Mounting Position	PCB Through Hole
Tan δ	2×10^{-4} Polypropylene
Terminal to Terminal Test	1.5 x Un 10 seconds
Terminal to Case Test	Ur-CASE = 2000 Vrms @ 50 Hz for 10 seconds
Reliability	100 FIT

Applications

Applications include but are not limited to: DC filtering, frequency converters, solar power inverters, and micro inverters.

Dimensions [mm]

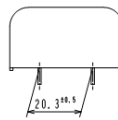
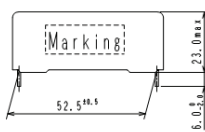
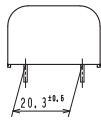
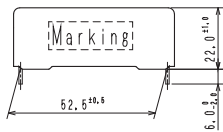
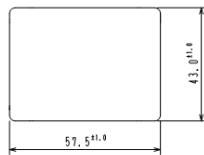
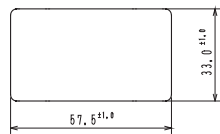

FIG. A

FIG. B

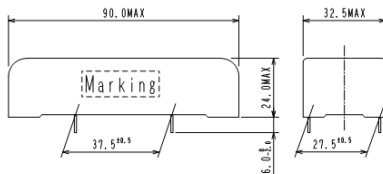

FIG. C

Specifications

Cap [μF]	I _{RMS} (10kHz) [A _{RMS}]	ESR (10kHz) [mΩ]	dV/dt [V/μs]	Max Tan δ (1kHz)	Lead Style	"W" [mm]	"H" [mm]	"T" [mm]	"P1" [mm]	"P2" [mm]	ød [mm]	Fig
450 VDC												
30	9.0	10.5	18	0.3%	2	57.5	33.0	22.0	52.5	20.3-	1.2	A
40	11.0	8.0	18	0.3%	2	57.5	23.0	43.0	52.5	20.3-	1.2	B
63	13.0	3.6	50	0.3%	4	90.0	24.0	32.5	27.5	37.5	0.8	C
850 VDC												
17	8.0	10.5	24	0.2%	2	57.5	33.0	22.0	52.5	20.3-	1.2	A
22	10.0	11.0	24	0.2%	2	57.5	23.0	43.0	52.5	20.3-	1.2	B
24	11.0	5.1	57	0.2%	4	90.0	24.0	32.5	27.5	37.5	0.8	C

American Shizuki Capacitors specializes in creating made-to-order solutions for your unique application. Please don't hesitate to ask us about customized components.