

Actuator

61-
0030.02



<https://www.eao.com/component/61-0030.02/en/a...>

Your product:



61-0030.02 Actuator

FRONT

| | |
|------------------------------|---------------|
| Front dimension: | 24 mm x 18 mm |
| Front form: | Rectangular |
| Front bezel colour: | Black |
| Front bezel material: | Plastic |

MOUNTING

| | |
|--------------------------|----------------|
| Mounting cut-out: | Ø 16 mm |
| Mounting type: | Panel mounting |

MECHANICAL CHARACTERISTICS

| | |
|---------------------------|--------------------------------|
| Terminal: | Plug-in terminal, 2.8 x 0.5 mm |
| Tightening torque: | Max. 0.5 Nm |
| Weight: | 0.007 kg |

AMBIENT CONDITION

| | |
|-------------------------------|---|
| IP Protection: | IP40 rear side, according to EN IEC 60529, IP67 front side, according to EN IEC 60529 |
| Operating temperature: | - 25 °C ... + 55 °C |
| Storage temperature: | - 40 °C ... + 85 °C |

CERTIFICATE

REACH: REACH compliant

RoHS: RoHS compliant

OTHER

Short Description: Actuator, Ø 16 mm, 24 mm x 18 mm, Rectangular, Black, Plastic, Plug-in terminal, 2.8 x 0.5 mm

Internal size: 21,5 mm x 15,3 mm

Housing colour: Black

Housing material: Plastic, according to UL 94 V0, self-extinguishing

Wiring diagrams:

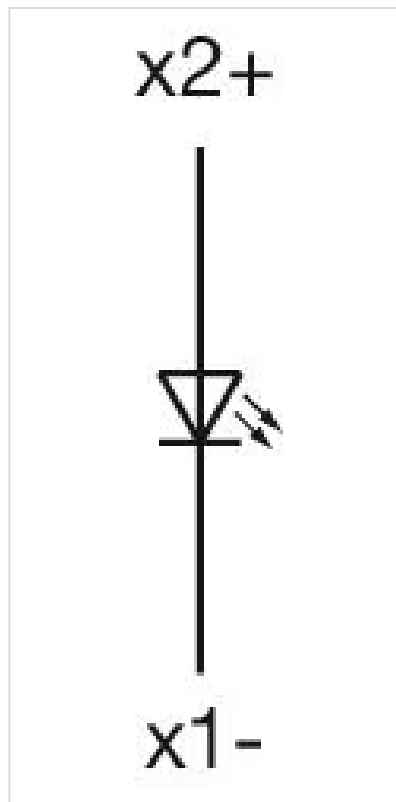

Mounting cut-outs:

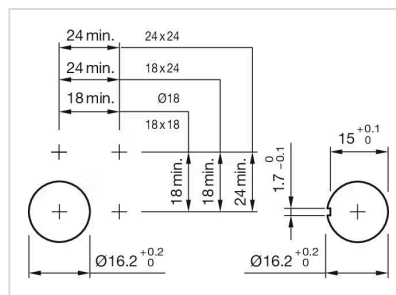

Dimension drawings:

